

SPOJNICE - L

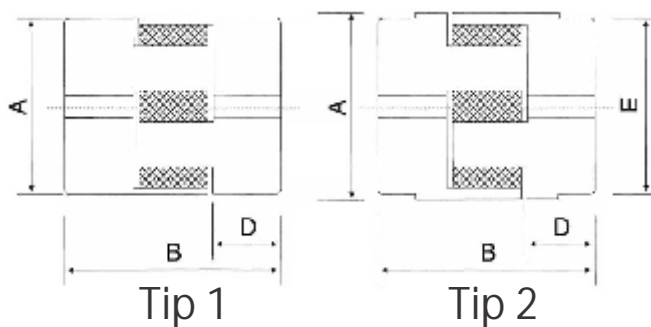

Veli ina	Tip	A	B	D	E	Std rupa	Širina rupe/mm		Težina kg	Cena €		
							min	max		metal	guma	Kompletna spojnica (guma + 2metala)
L035	1	16	20,5	6,6	/	3	3	8	0,12	1.88	0.93	4.96
L050	1	28	43,2	15,6	/	6	6	15	0,16	2.19	1.04	5.42
L070	1	35	50,8	19	/	9	9	19	0,4	2.33	1.32	5.98
L075	1	45	54,7	21	/	9	9	25	0,55	3.24	1.68	8.16
L090	1	54	54,7	21	/	9	9	28	0,8	3.60	2.01	9.21
L095	1	54	63,7	25,5	/	9	9	28	0,88	3.77	2.09	9.263
L100	1	64,5	88,5	35	/	12	12	35	1,75	7.85	2.56	18.26
L110	1	85	108	43	/	15	15	48	3,62	11.22	4	26.44
L150	1	96	115,4	45	/	15	15	48	4,9	15.71	6.3	37.22
L190	2	115	133,4	54	101,6	19	19	55	7,7	21.63	8.38	51.64

SPOJNICE - GE-GR

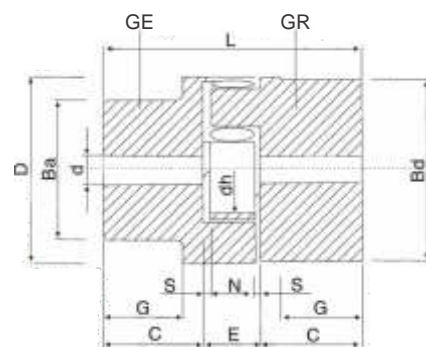

Veli ina	Komponenta	Splder(deo2)obrt.mom.(NM)					Završna rupa										Težina kg	Cena €		
		92 Sh A	98 Sh A	64 Sh D	(d)	(d)min-max	L	C	E	N	S	D	dh	ba:bd	G	metal		guma	Kompletna spojnica (guma + 2metala)	
19/24	GE	10	17	21	6	6-16	66	25	16	12	2	40	18	32	20	0,55	2.64	1.76	7.04	
	6				6-24	40								/						
24/32	GE	35	60	75	9	9-24	78	30	18	14	2	55	27	40	24	0,95	3.70	2.46	9.86	
	9				9-32	55								/	1,17					
28/38	GE	95	160	200	10	10-28	90	35	20	15	2,5	65	30	48	28	1,6	5.98	3.98	15.94	
	10				10-38	65								/	1,95					
38/45	GE	190	325	405	12	12-38	114	45	24	18	3	80	38	66	37	3	8.98	5.98	23.94	
	12				12-45	78								/	3,8					
42/55	GE	265	450	560	12	12-42	126	50	26	20	3	95	46	75	40	4,45	13.05	8.69	34.79	
	12				12-55	94								/	6					
48/60	GE	310	525	655	12	12-48	140	56	28	21	3,5	105	51	85	45	6,15	16.68	11.34	44.7	
	12				12-60	104								/	8					
55/70	GE	410	685	825	15	15-585	160	65	30	22	4	120	60	98	52	9,5	25.90	15.65	67.45	
	15				15-70	118								/	12,35					

cene su bez PDV-a

Cene su podložne promenama - postoji mogućnost odobravanja rabata
+381 18 226 364, 018 222 927, 064 89 00 735

www.ami.rs

ZVEZDASTA SPOJNICA "SKF"

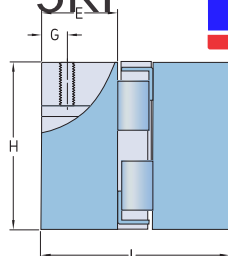
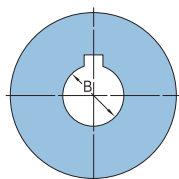

Oznaka	Velicina	B min	B max	L	E	H	G	Zavrtnaj za osiguranje	Masa	Brzina n max	Gumena zvezda	Metalna glavcina	Kompletna spojnica (guma + 2metala)
		mm	mm										mm
PHE L035	035	3,20	9,5	20,6	6,7	15,9	/	/	0,03	31 000	1,33	2,68	6,70
PHE L050	050	6,35	14,0	44,0	16,0	27,5	6,5	M6	0,05	18 000	1,50	3,13	7,75
PHE L070	070	6,35	19,0	51,0	19,0	35,0	9,5	M6	0,12	14 000	1,90	3,33	8,55
PHE L075	075	6,35	24,0	54,0	21,0	44,5	9,0	M6	0,22	11 000	2,40	4,62	11,65
PHE L090	090	6,35	24,0	54,0	21,0	54,0	8,7	M6	0,28	9 000	2,86	5,14	13,15
PHE L095	095	11,11	28,0	64,0	25,0	54,0	11,0	M8	0,31	9 000	2,86	6,05	14,98
PHE L100	100	12,70	35,0	89,0	35,0	65,0	11,0	M8	0,75	7 000	3,66	9,20	22,07
PHE L110	110	15,87	42,0	108,0	43,0	84,0	19,0	M10	1,50	5 000	5,70	16,02	37,75
PHE L150	150	15,87	48,0	115,0	45,0	96,0	22,0	M10	2,40	4 000	9,00	22,44	53,88
PHE L190	190	19,05	55,0	133,0	54,0	102,0	22,0	M12	3,50	3 600	11,95	30,90	73,77
PHE L225	225	19,05	60,0	153,0	64,0	108,0	29,0	M12	4,50	3 600	14,55	41,55	97,66

KARDANSKI ZGLOB "SKF"

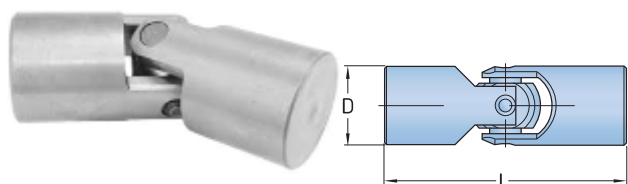

Dupli

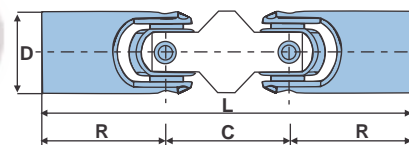

Oznaka	L	D	Obrtni moment	Cena
	mm	mm		
PHE WMA10	38	10	13.5	12.50
PHE WMA13	45	13	26	12.50
PHE WMA16	52	16	45	12.50
PHE WMA20	62	20	88	12.50
PHE WMA25	74	25	180	13.00
PHE WMA32	86	32	405	15.00
PHE WMA40	108	40	860	16.50
PHE WMA45	120	45	1250	20.00
PHE WMA50	132	50	1730	27.00
PHE WMA63	166	63	3400	36.00

Oznaka	L	D	R	C	Obrtni moment	Cena
	mm	mm	mm	mm		
PHE 16	77	16	26	25	45	18.00
PHE 20	92	20	31	30	88	20.00
PHE 25	110	25	37	36	180	21.00
PHE 32	133	2	43	47	405	24.00
PHE 40	164	40	54	56	860	33.00
PHE 45	183	45	60	63	1250	39.00
PHE 50	202	50	66	70	1730	47.00
PHE 63	250	63	83	84	3400	55.00

*** Napomena: Telo zgloba nije probušeno, rupa se buši naknadno po potrebi

*** Napomena: Telo zgloba nije probušeno, rupa se buši naknadno po potrebi cene su bez PDV-a